

neakasa[☆]
Formerly Neabot

NEAKASA PET GROOMING KIT & VACUUM

P1 PRO

USER GUIDE

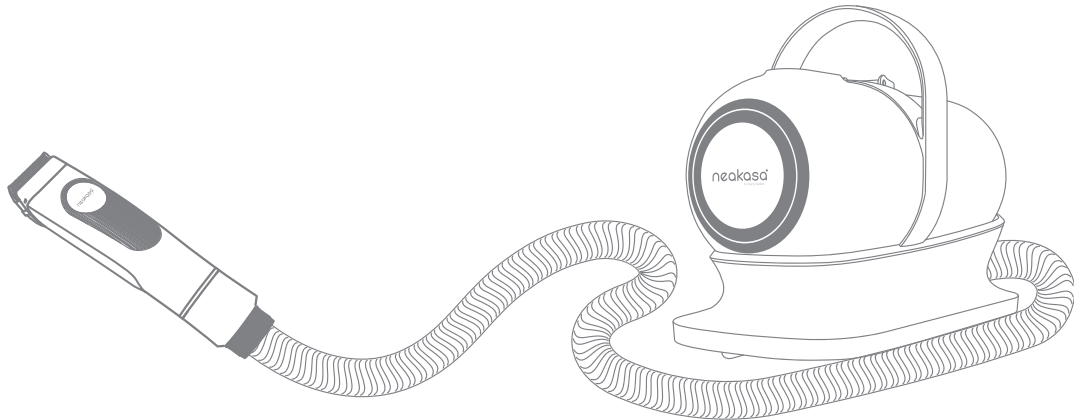

User Guide

- Safety Information 1-2
- Package Includes 3
- Get Started 4-6
- Customer Support 7
- Care and Maintenance 8-11
- Specifications 12
- Warranty 13

IMPORTANT SAFETY INSTRUCTIONS

When using an electrical appliance, basic precautions should always be followed, including the following:

Read all instructions before using

WARNING – To reduce the risk of fire, electric shock, or injury:

- This product is only for household use, not for commercial or industrial use, nor for outdoor or humid places;
- Never use this product alone for children or people with weak thinking ability;
- When using it, please use it in an environment where it can be used safely and under the instructions and supervision of a person who understands the safe use of the product and its hazards. Under such circumstances, please never let children use it;
- Please pay full attention when using it near children and pets. In addition, please be careful not to let children and pets play with this product;
- Please do not touch the power plug and this product with wet hands, please do not absorb moisture and liquid;
- Please do not use this product when the power cord or power plug is damaged;
- In the case of this product not working normally, in the case of damage, placed outdoors or immersed in liquid, please be sure to contact our company;
- Please do not disassemble the product, wrong assembly method may cause electric shock or fire, please contact our company when you need repair;
- Please do not inhale flammable or combustible liquids such as gasoline. In addition, please do not use it in an environment with flammable or combustible gas or nearby;
- Do not pull the power cord, do not put heavy objects on the top of the machine, and do not clamp the wires to close the door;
- Please do not smoke anything that is on fire, smoking or high temperature such as cigarettes, matches, hot soot;
- Please do not put anything into the opening or block the opening for use;
- After use, please pull out the plug from the socket before maintenance or parts replacement;
- Please do not use or keep it in humid places such as outdoors or in the bathroom, or where a glass of water is wet;
- Please do not use products with fragrances and fragrances as filters. Such chemicals may become one of the causes of fire.
- Do not leave appliance when plugged in. Unplug from outlet when not in use and before servicing.
- **WARNING – To Reduce The Risk Of Electric Shock – Do not use outdoors or on wet surfaces.**
- Use only as described in this manual. Use only manufacturer's recommended attachments.
- Do not use with damaged cord or plug. If appliance is not working as it should, has been dropped, damaged, left outdoors, or dropped into water, return it to a service center.
- Do not pull or carry by cord, use cord as a handle, close a door on cord, or pull cord around sharp edges or corners. Do not run appliance over cord. Keep cord away from heated surfaces.
- Do not handle plug or appliance with wet hands.
- Keep hair, loose clothing, fingers, and all parts of body away from openings and moving parts.
- Turn off all controls before unplugging.
- Do not use without dust bag and/or filters in place.

IMPORTANT SAFETY INSTRUCTIONS

Cautions

- **Please do not operate or unplug the power cord with wet hands.**
In order to avoid malfunction and electric shock, please absolutely prohibit.
- **Please do not smoke and other highly flammable things.**
- **Please do not use in places with flammable or flammable liquids.**
Because it may cause fire and explosion, please do not inhale highly flammable liquids and combustibles.
- **There may be a peculiar smell when used for the first time, but it will not cause adverse effects on the body.**
When using this product for the first time, there will be an odor but it will disappear after a while. Please understand. However, if the burnt smell persists, please stop using it immediately!
- **Please keep the dust cup and filter clean for a long time.**
If the dust cup and filter are used when they are dirty, they may be the cause of malfunction, and unexpected accidents may occur.
- **When maintaining, be sure to cut off the power and unplug the power cord before proceeding.**
If the power is turned on for maintenance, there will be a risk of electric shock, accidents and injuries.
- **This product stops its operation when the temperature rises abnormally.**
If abnormal heating of the motor occurs, the operation will be stopped immediately, if the suction port is blocked, the operation will be stopped immediately, take out the dust cup, confirm that the suction port and filter are clean, and then open it after 60 minutes.
- **Be sure to use each filter with the installed state.**
Please be sure to install and use the filter. If the filter is removed and used, it will be one of the reasons for the failure.

SAVE THESE INSTRUCTIONS

To reduce the risk of electric shock, this appliance has a polarized plug (one blade is wider than the other). This plug will fit in a polarized outlet only one way. If the plug does not fit fully in the outlet, reverse the plug. If it still does not fit, contact a qualified electrician to install the proper outlet. Do not change the plug in any way.

Package Includes

Front View

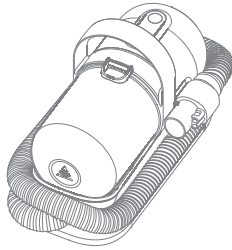

Vacuum Device*1



User Guide*1

Accessories



Grooming Brush*1



Deshedding Tool*1



Electric Clippers*1



Cleaning Brush*1



Nozzle*1



HEPA*1

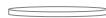

Sponge Filter*1



Wind Cover*1

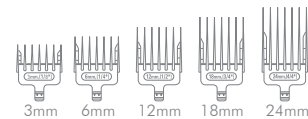

Clipping Comb*5

Note: If you find something missing in your package, please contact customer support via support@neakasa.com in time.

Get Started

Get Ready

Put the dust cup gently in the direction of the arrow.

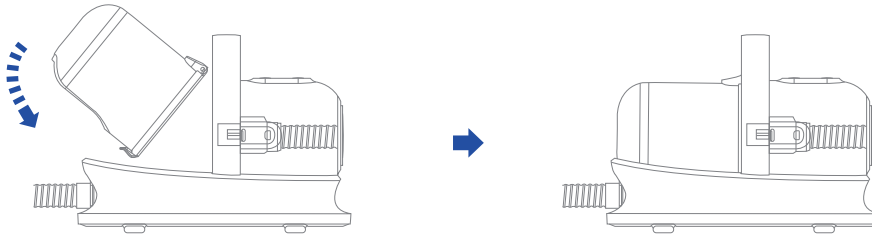

Connect the Accessory to the Vacuum Cleaner Through the Hose

When using accessories, please pay attention to the edges of the accessories to avoid scratching your hands.

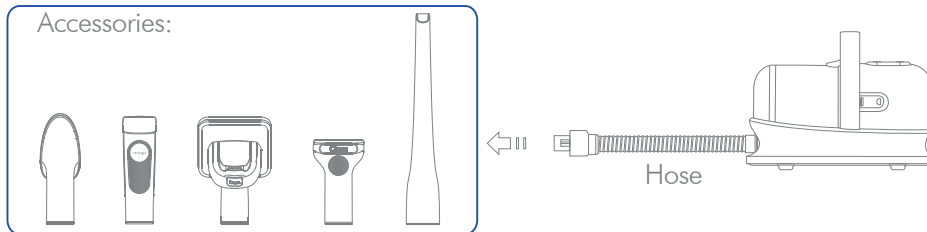

Get Started

Adjustment of Electric Clippers

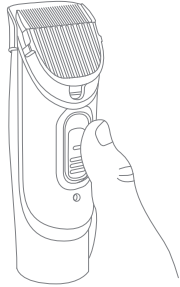

Reduce hair retention length

Slide up (don't press the yellow self-locking button)

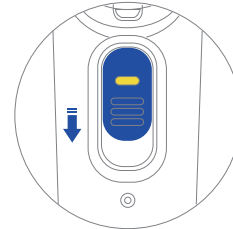

Increase hair retention length

Slide down (press and hold the yellow self-locking button)

Use the Device

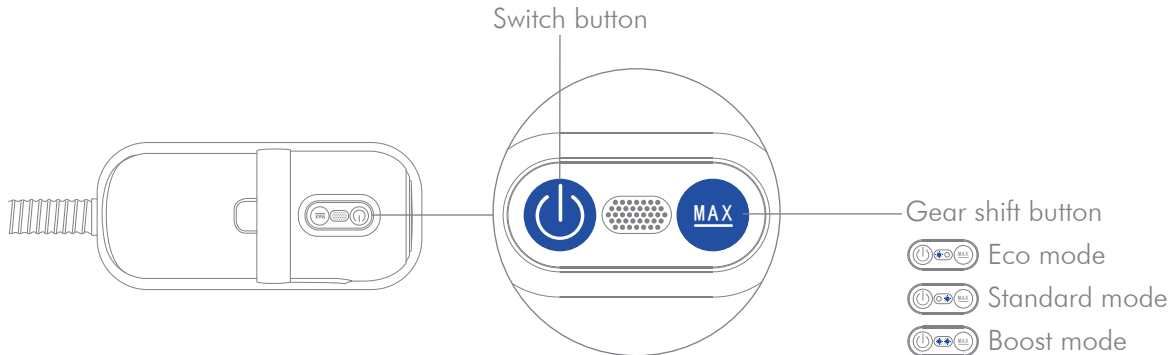

Get Started

Use of Accessories

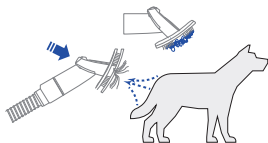

Grooming Brush

It can clean the floating hair on pets and the garbage in the hair, and at the same time it has the function of lengthening the hair, making the hair more fluffy.

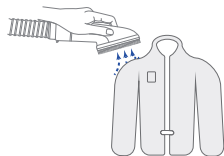

Cleaning Brush

It can clean the hair from pets or from people's clothes.

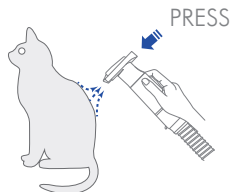

Deshedding Tool

Quickly and easily remove loose hair for long and short haired dogs and cats. Effectively reduce shedding by up to 95% of dead hair and tangles.

Note: During the use, please pay attention to the cutting edge and sharp position, do not use excessive force to cause the Skin scratches.

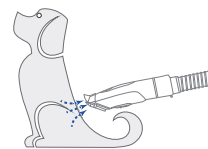

Electric Clippers

It can shave your pet's hair and suck it into the dust cup to prevent it from falling elsewhere.

Note: Please be careful on the soft parts of the pet's skin and do not use excessive force to cause skin scratches.

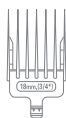

Clipping Comb

According to different hair style needs to choose.(optional use)

Note: The objects are scattered and small, please keep them properly when not in use.



Wind Cover

It is used to enhance the suction force of the tuyere when trimming hair, and at the same time guide the path of the suction port.(optional use)

Note: The objects are scattered and small, please keep them properly when not in use.

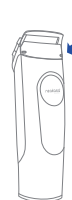

Customer Support

If you have other questions or comments about your product, please contact us via support@neakasa.com or our Facebook [@neakasa.tech](https://www.facebook.com/neakasa.tech).

Care and Maintenance

Clean the Dust Cup

1. Remove the dust cup: Lift slightly in the arrow direction to remove the dust cup.

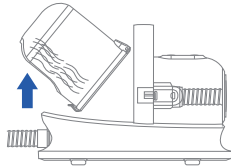

2. Open the lid to dump out the trash: push the blue buckle to open the dust cup and dump out the trash.

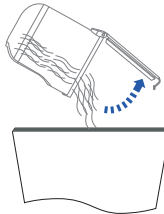

3. Install the dust cup: install the dust cup in the direction of the arrow.

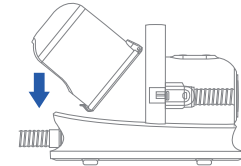

Note:

- Be careful when handling the dust cup.
- If the removed dust cup is cleaned after being dumped with dust, remember to install the dust cup after it is dry to prevent water ingress in the motor and cause electric shock or damage to the machine.

Clean the Electric Clippers

1. Please retract the movable knife adjustment knob to the bottom before installing the knife.



2. Vacuum/clean debris from the blade and the clipper.

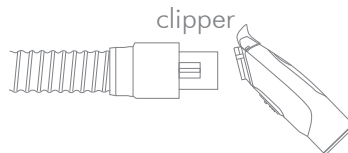
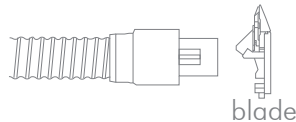

3. Drop the lubricant (Not included) on the blade.



Care and Maintenance

Clean HEPA

1. Remove the dust cup, take out the HEPA.

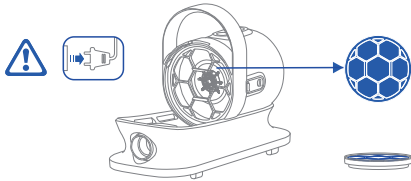

2. Wash with water, drain the water after washing.



3. Place it in a well-ventilated place for at least 24 hours of drying.

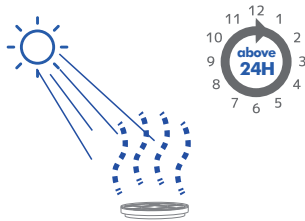

4. Install the HEPA back to the original place after it is completely dry, please be sure to install it.

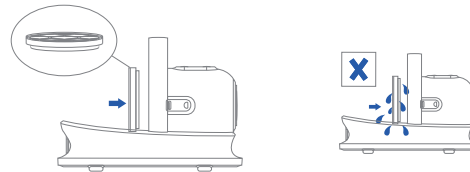

Note:

- The filter should be cleaned with cold water at least every other month.
- Please follow the frequency of use and conditions, the maintenance period is also different, regularly confirm if it is dirty, clean it.
- When cleaning, remember to disconnect the power supply and unplug the plug from the socket.
- Be sure to install HEPA after drying.
- No-yet-dry HEPA can cause electric shock and malfunction.

Care and Maintenance

Cleaning the Sponge Filter

1. Remove the dust cup and take out the sponge.

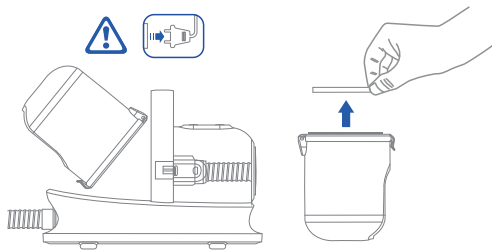

2. Please wash with tap water, and drain the water after washing.

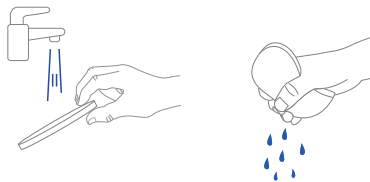

3. Put it in a well-ventilated place for at least 24 hours of drying treatment.

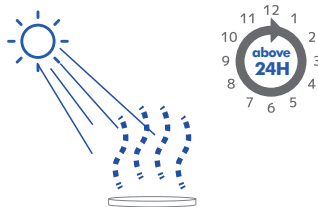

4. Install the sponge back to its original place after it is completely dry. Be sure to install the sponge.

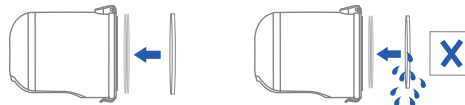

Note:

- The filter should be cleaned with cold water at least every other month.
- Please follow the frequency of use and conditions, the maintenance period is also different, regularly confirm if it is dirty, clean it.
- When cleaning, remember to disconnect the power supply and unplug the plug from the socket.
- Be sure to install sponge filter after drying.
- No dry sponge filter can cause electric shock and malfunction.

Care and Maintenance

Hose Storage Method

Wrap the hose clockwise around the fuselage, and the hose snaps into the buckle on the side of the fuselage to fix it.

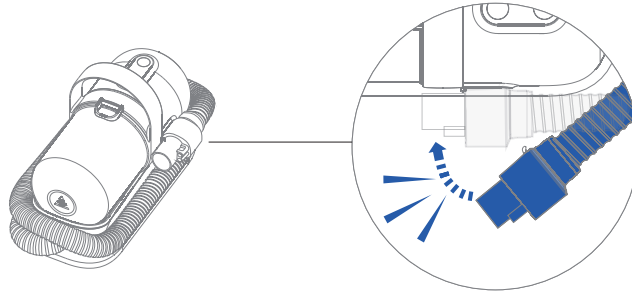

Power Cord Storage Method

The machine plug cord is wound and stored to the bottom of the fuselage.

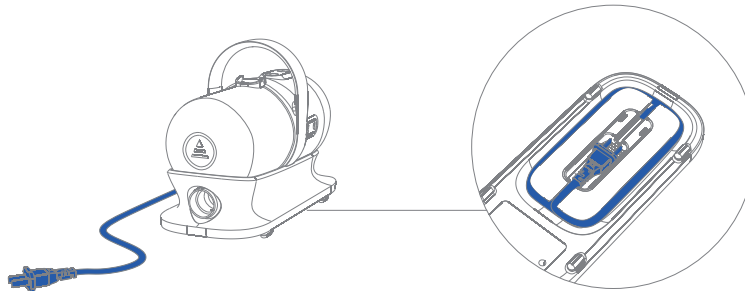

Specifications

Power:	300 W
Hose Length:	1.3 m / 51.2 inch
Suction Power:	35 W
Dust Cup Capacity:	1 L / 33.8 oz
Product Size:	290*132*210 mm / 11.4*5.2*8.3 inch
Wire Length:	2.5 m / 98.4 inch
N.W.:	2 kg / 4.4 lbs
Maximum Noise:	76 dBA

Warranty

1. The warranty period is 12 months from the date of purchase. The warranty is only limited to free repair of the product purchased. Consumables and accessories are not subject to warranty.
2. If it is damaged or malfunctioned during normal use, it will be repaired free of charge within the warranty period. If it cannot be repaired, a replacement will be provided.
3. The following conditions are paid repairs even during the warranty period:
 - (a) Failure and damage caused by misuse or carelessness;
 - (b) Damage due to shipping;
 - (c) Damage caused by pets (scratches, bites, touching the body or riding products);
 - (d) Failure and damage caused by fire, earthquake, and other natural disasters;
 - (e) Failure and damage during use other than general household use (long-term use for business, etc.);
 - (f) After the purchase time reaches 12 months.
4. In the following situations, no repairs will be provided regardless of the warranty period:
 - (a) Products not purchased directly from Neakasa sales channels (e.g personal sales, auctions, etc.);
 - (b) The customer opens the product or tries to reform it;
 - (c) Consumables and accessories.
5. Shipping cost will be borne or reimbursed by Neakasa when the product is covered by warranty service. However cost of packaging materials will not be covered.
6. If it is not covered by the warranty, shipping cost and repair fees will be charged when returning.
7. The warranty period for the exchange product is subject to the warranty period before the exchange (counted from the original purchase date);
8. Repair or replacement is only valid in certain countries.
9. Please contact support@neakasa.com for guidance if you have a question or need to repair.
10. Regulations may be changed without notice. Neakasa reserves the rights to update warranty when needed. All repairs and request will be handled according to the most updated warranty.