

Keypad Digital Deadbolt

Installation Guide / Programming Instructions

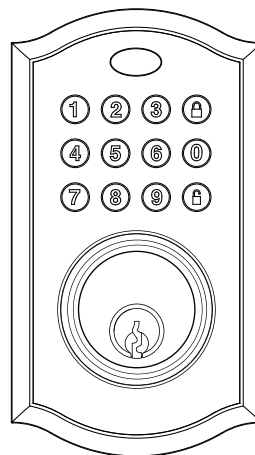

Thank you for purchasing our products. Please read this manual thoroughly before operating your device.
All pictures in this manual are for illustration purpose only. Actual product may vary due to product upgrade.



Get 24/7 Assistance at



Or Visit:
<https://elamor2.afterservice.vip>



Installation Overview

△ Read this manual carefully before installing and operating!

- P 3 *STEP 1: Prepare the door and check dimensions*
- P 6 *STEP 1-1: Instructions for drilling a new door*
- P 9 *STEP 2: Install the latch and strike*
- P 11 *STEP 3: Install exterior assembly*
- P 12 *STEP 4: Install interior assembly*
- P 14 *STEP 5: Install the batteries and perform the door handing process*

Programming Instructions

- P 15 *At a Glance*
- P 16 *How to Use*
- P 17 *Definitions*
- P 17 *Code Format*
- P 18 *Quick Set Up*
- P 20 *Protection Mode*
- P 21 *Factory Default Settings*
- P 22 *System Alerts*
- P 23 *Troubleshooting*
- P 24 *Warranty*

TOOL REQUIRED:



Do not use an electric screwdriver during installation.

IMPORTANT:



Do not load batteries until lock is completely installed.







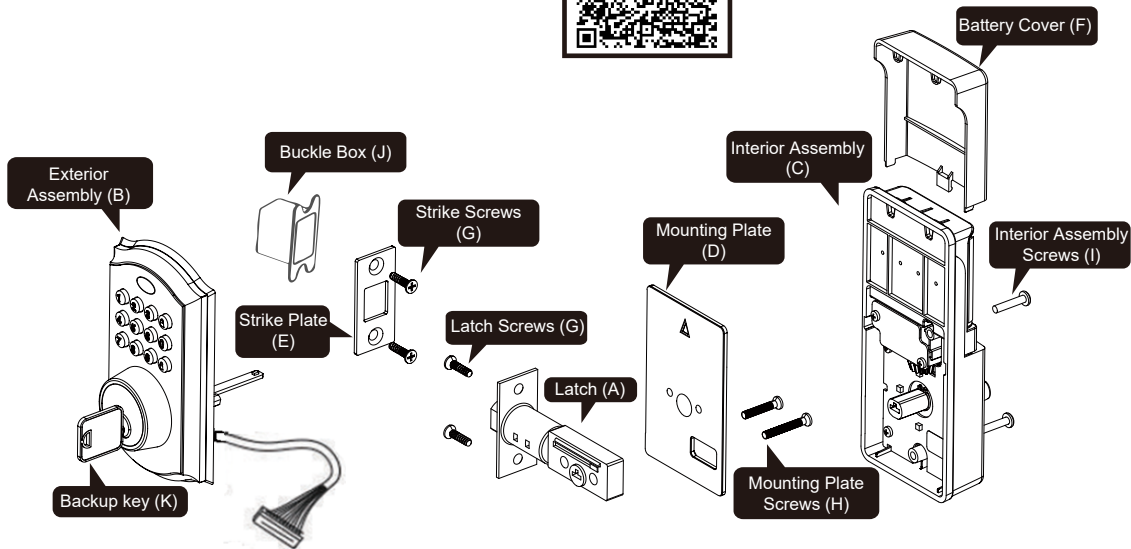

INSTALLATION OVERVIEW

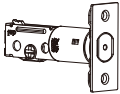
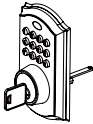

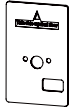
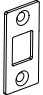
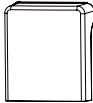
Please scan the QR code to access online videos on how to install your lock.



Parts List

<p>A Latch x1</p> 	<p>B Exterior Assembly x1</p> 	<p>C Interior Assembly x1</p> 	<p>D Mounting Plate x1</p> 
<p>E Strike Plate x1</p> 	<p>F Battery Cover x1</p> 	<p>G 3/4"(19mm) Strike/Latch Screws x4</p> 	<p>H 1-5/32" (33mm) Mounting Plate Screws x2</p> 
<p>I 3/4"(19mm) Interior Assembly Screws x2</p> 	<p>J Buckle box x1</p> 	<p>K Backup key x2</p> 	

If any parts are missing or damaged, please contact Customer Support.

STEP

1 Prepare the door and check dimensions

If you need to drill a new door, use the supplied template and the complete door drilling instructions.

A

Measure to confirm that the hole in the door is 2-1/8" (54mm).

Measure to confirm that the hole in the door edge is 1" (25mm).

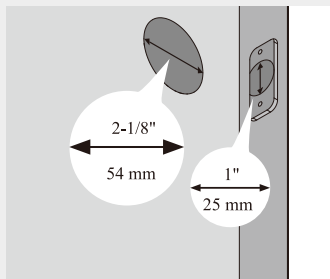

B

Measure to confirm that the backset is either 2-3/8" or 2-3/4" (60 or 70mm)

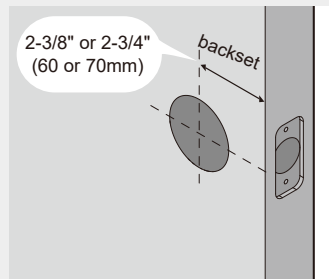

C

Measure to confirm that the door is 1-3/8" to 2" (35 mm or 50mm) thick.

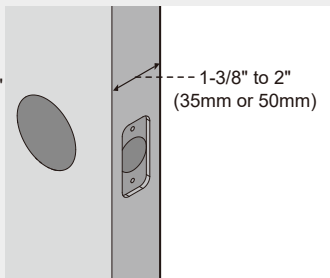

D

Make sure the hole in door frame is drilled a minimum of 1" (25mm) deep.

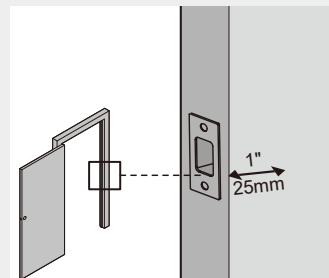

Template

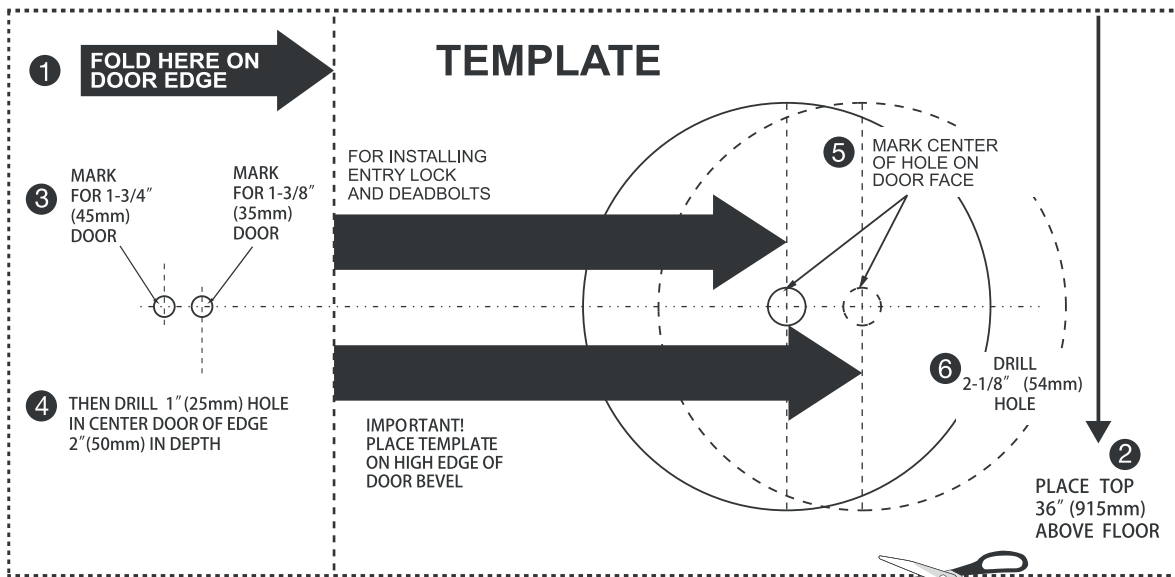



STEP

1-1 Instructions for drilling a new door

1. TEMPLATE

1-a. Cut out template printed in this manual.

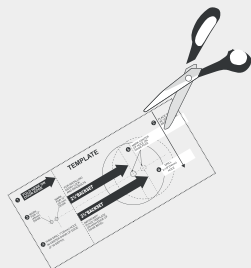

1-b. Fold template and place on door 36" (915mm) from the ground as marked.

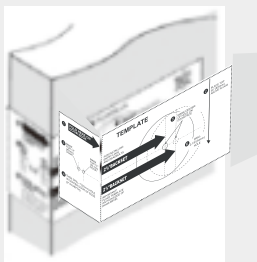

2. MARK THE DOOR FOR DRILLING

2- a. Mark center hole on door edge through guidance on template for 1" (25mm) latch bolt.



2-b. Mark center hole on door face through guidance on template for 2-3/8" (60mm) or 2-3/4" (70mm) backset.



3. DRILL AND CHISEL DOOR

3-a. Drill 2-1/8" (54mm) hole through door panel as marked for lock set.

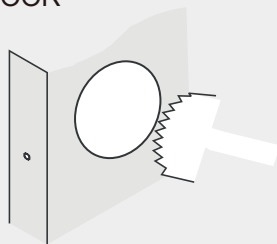

3-b. Drill 1" (25mm) hole in center of door edge for Deadbolt Latch Assembly.

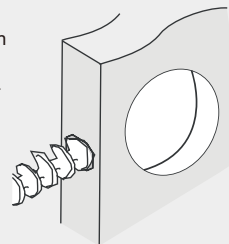

3-c. Insert Deadbolt Latch Assembly in hole keeping it parallel to face of door. Mark outline and remove latch.

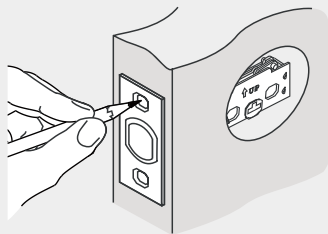

3-d. Chisel 5/32" (4mm) deep or until latch face is flush with door edge.

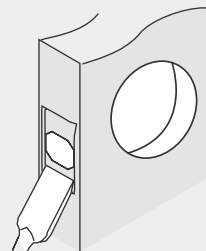

NOTE: For Drive in Latch, drill hole size indicated on template and press until it is flush with door edge.

4. MARK AND DRILL DOOR JAMB

4-a. Mark center hole on edge of jamb even with the center of the Latch Bolt on door edge.

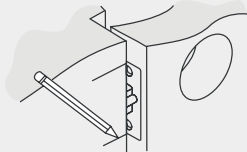

4-b. Drill 1" (25 mm) hole 1-3/16" (30 mm) deep in door jamb on center mark.

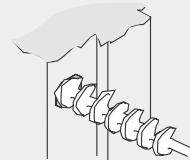

4-c. Outline outside edges of Strike Plate.

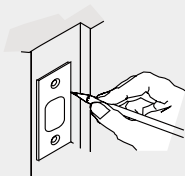

4-d. Chisel 5/32" (4 mm) deep for Strike Plate or until it is flush with door surface.

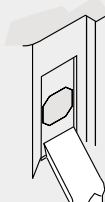

4-e. Install Strike Plate using two 3/4" (19 mm) screws provided.

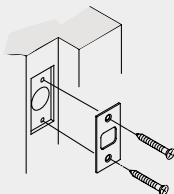

STEP

2 Install the latch and strike

A Determine backset and adjust the latch

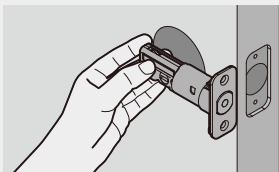

Hold the latch in front of the door hole, with the latch face flush against the door edge. Is the slotted hole centered in the door hole?

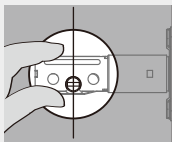

YES

No adjustment is required.
Proceed to next step.

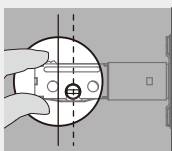

NO

Slotted hole is NOT centered.

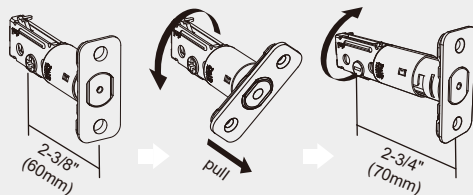

Twist the latch and adjust the bolt length.
(Make sure the latch bolt is retracted.)

B

Install the latch

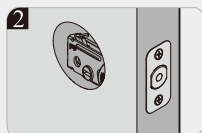
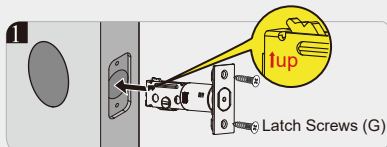
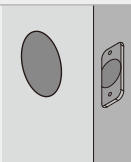

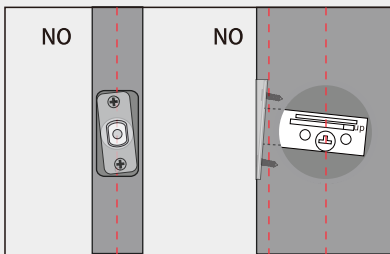

C Use a screwdriver to test if deadbolt works smoothly.

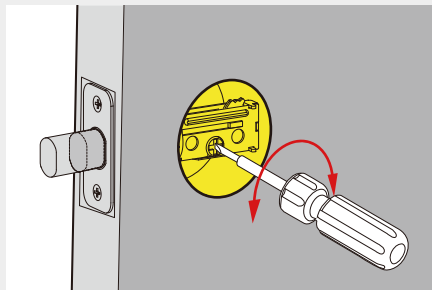

D Install strike on the door frame.

! IMPORTANT:

Make sure the hole in door frame is drilled a minimum of 1" (25mm) deep.

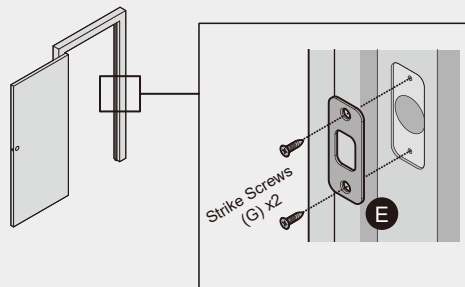

STEP

3 Install exterior assembly

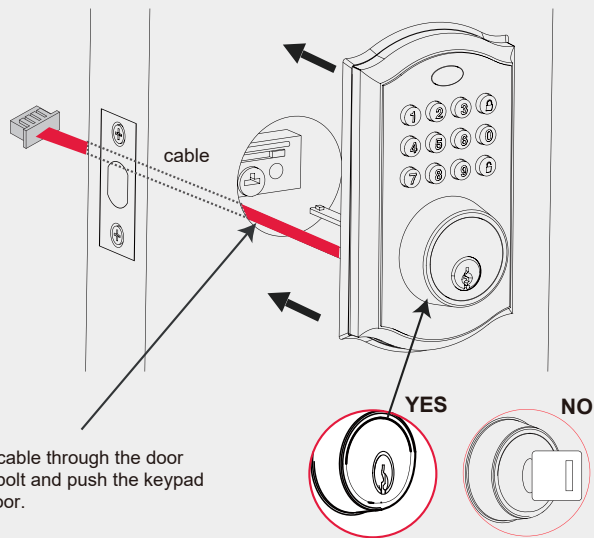

! IMPORTANT:

The key must be pulled out when installing.

STEP

4 Install interior assembly

- 1 Take off the mounting plate (D).



IMPORTANT:

Do not load batteries until lock is completely installed.

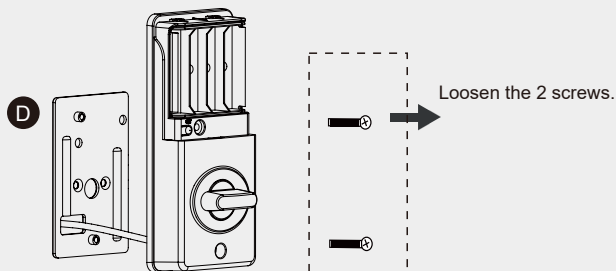

- 2 Route cable through the bottom of mounting plate.

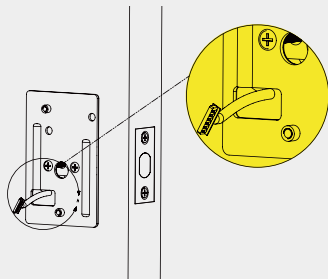

- 3 Tighten screws.

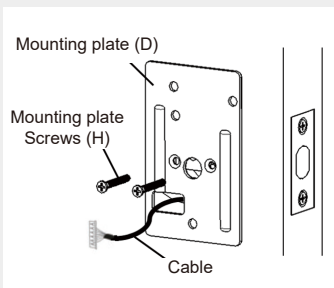

Note: Please support exterior assembly during mounting plate installation.

4 Ensure tight cable connection.

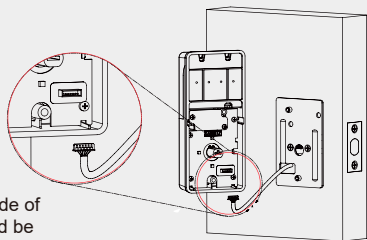

The smooth side of the plug should be at the bottom.

5 Tighten screws.

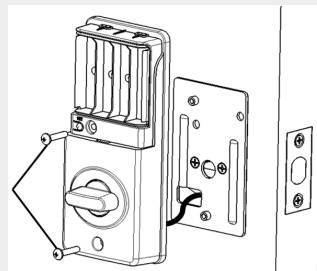

Interior assembly screws (I)

6 Insert key and test latch.

If latch does not extend or retract smoothly, adjust mounting plate screws.

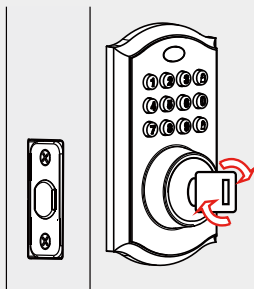

If the keypad and mounting plate are deflected, loose mounting plate screws and adjust.

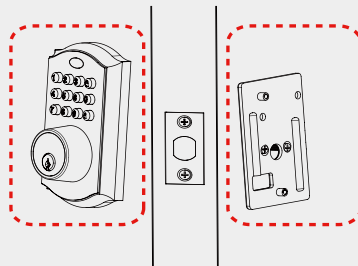

STEP

5 Install the batteries and perform the door handing process

- 1 While the door is OPEN and UNLOCKED, load 4 AA batteries into the battery compartment..

! IMPORTANT:

Do not use rechargeable batteries or non-alkaline batteries.

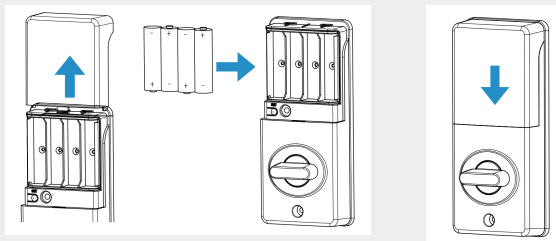

The batteries are not included.

- 2 Perform the door handing process.

a. Press , the latch bolt extends by itself.

b. Enter preset programming code:123456, then press , the latch bolt retracts by itself.



If the latch bolt cannot extend or retract smoothly, check the latch and re-install the lock.

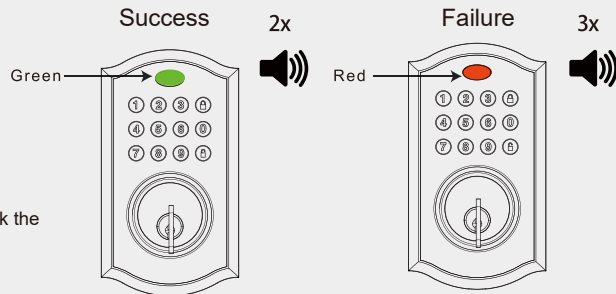

Make sure the door is unlocked and that you are using a fresh set of batteries.

PROGRAMMING INSTRUCTIONS

At a Glance

Exterior Assembly

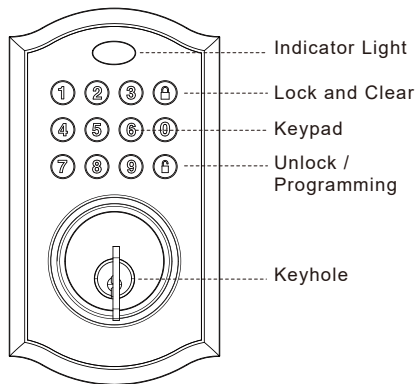

Interior Assembly

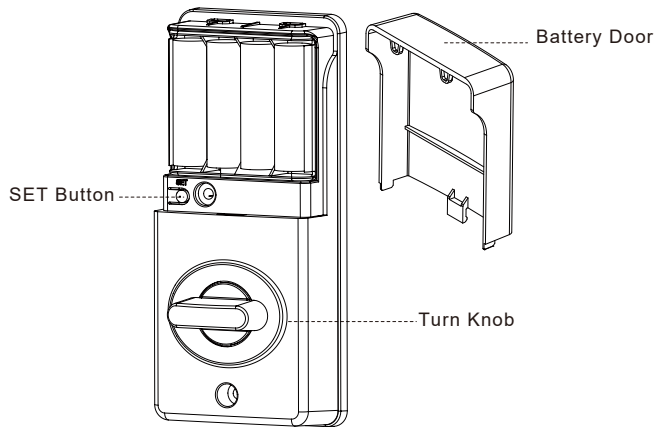

How to Use

UNLOCK the door from outside

Master code +  or User code + 

LOCK the door from outside

Auto Lock Mode

In Auto Lock mode, the bolt will extend out automatically in 10 seconds after unlocking.

Manual Mode

Press .

UNLOCK the door from inside

Rotate the thumb turn to horizontal position.

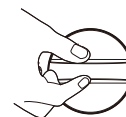

LOCK the door from inside

Auto Lock Mode

In Auto Lock mode, the device will be locked automatically.

Manual Mode

Rotate the thumb turn to vertical position.

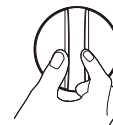

- **Master Code**

Required for programming and feature settings. Master code can be used to unlock the door. The default master code needs to be changed before programming.

For safety concerns, please keep this information confidential.

- **Auto Lock**

Automatically locks the deadbolt 10 seconds after unlocking. You can customize the Auto Lock time delay between 5-30 seconds.

- **Key Unlock**

Key Unlock is always available when the batteries are completely dead or valid User Codes are forgotten.

- **Low Battery Indicator**

If you see red light flashing after pressing any key, that's an alert for replacing batteries. Please replace with 4 brand new AA alkaline batteries and do not mix used and new batteries.

- **Wrong Entry Limit**

After 5 incorrect user codes are entered within one minute, the lock will shut down for 90 seconds. Please re-enter a user code after 90 seconds.

- **Silent Mode**

The beep sounds when pressing keypad can be muted. But you will still hear low battery and system alerts.

Code Format

1. Master Code (6 digits): The default Master Code is **123456**. It is required that you change it to your own before programming.
2. User Code (6-9 digits): A total of 50 User Codes can be programmed and stored.
3. User ID (2 digits): From 01 to 50.

Factory default settings:

- Programming Code: 123456
- User Code: 123456
- User ID 01

Quick Set Up



IMPORTANT:

The default Master Code is **123456**
It is required that you change it to your own
before programming.

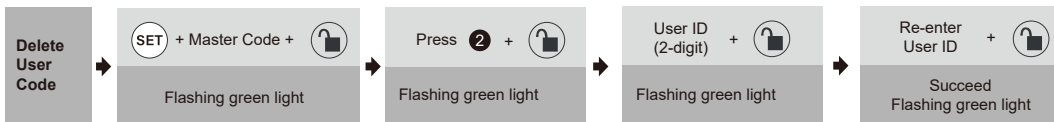
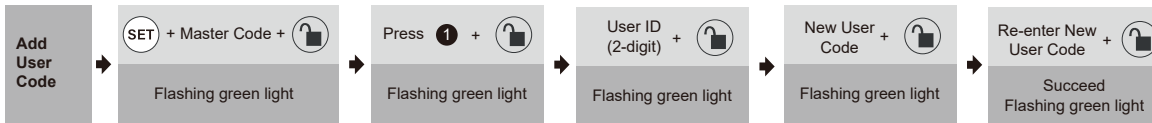
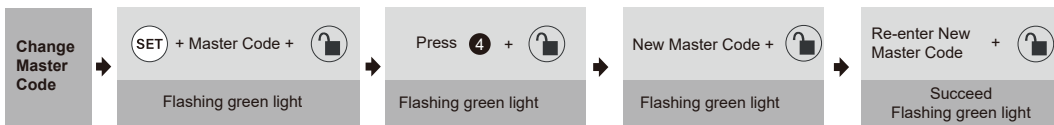

Make sure you have more than 1 user code or else you can not delete it.



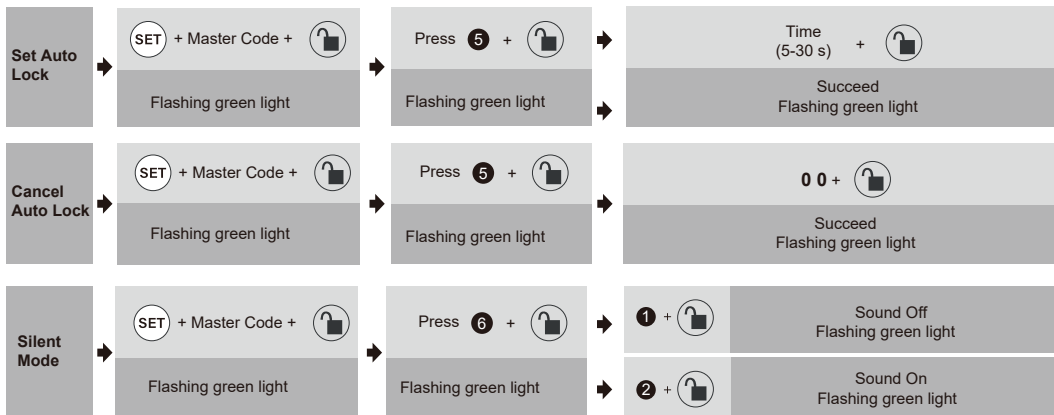

Notes:

1. If the indicator light flashes red, it means your setting failed. To continue your programming, press **SET** to re-enter programming mode.
2. The **SET** button is inside the battery compartment.
3. When you enter a wrong button, you can press to clear it.

Please scan the QR code to access online videos on how to set up your lock.





Protection Mode



If you enter a wrong code 5 times within one minute, the keypad will be locked for 90 seconds. If you press any button during this period, you will hear 3 beeps together with 3 red light flashes.

How to exit protection mode:

Option 1. Wait for 90 seconds and the lock will exit protection mode automatically.

Option 2. Remove the battery for more than 5 seconds, and then re-insert the battery.



→ 20



Factory Default Settings

How to Reset?

! IMPORTANT: The resetting will delete all User Codes stored in the lock.

Step 1. Keep the door open and unlocked.

Step 2. Open the battery cover.

Step 3. Keep pressing the SET button for more than 5 seconds until the lock gives 5 short beeps and light flashes blue 5 times, then the beep sounds for 1 second and green light flashes once.

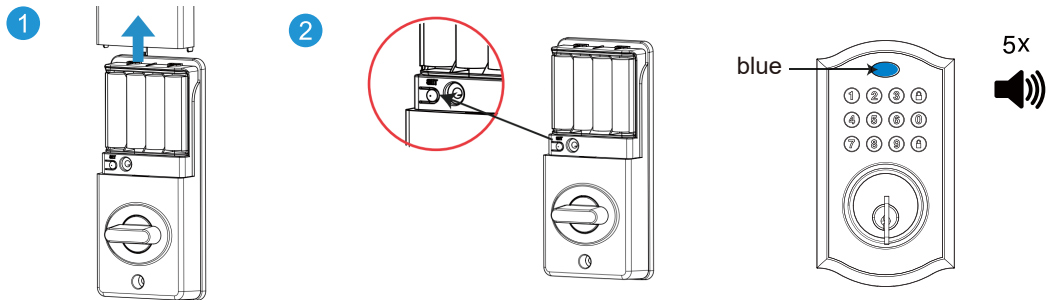

System Alerts

Alert	Possible cause	Solution
Light flashes red 3 times with 3 beeps.	Door jammed while attempting to lock.	Manually re-lock door. If needed, re-position strike.
	Unsuccessful programming.	Re-start programming procedure.
	Incorrect User Code entered.	Re-enter User Code.
Light flashes red 3 times with 3 beeps.	5 incorrect User Codes entered within one minute.	Re-enter User Code 90 seconds after keypad lock out.
Red light when pressing any button.	Low battery.	Replace batteries.
Red light when pressing any button; cannot unlock/lock.	Super low battery.	
Green light and beeps for 1s after pressing unlock/lock button. The lock gives no response.	Poor quality battery.	
The keypad and light indicator give no response.	Battery run out.	Replace batteries.
	Bad cable connection.	Re-connect the cable.



Troubleshooting



Why does not the latch extend but the motor is rotating when resetting my lock?

Improper installation may have caused the issue. Please follow the steps to review:

1. Please make sure the latch and strike are aligned.
2. Please slightly loosen the mounting screws on the external assembly keypad and the latch bolt if the screws are over-tightened.
3. Please open your door and reset the lock.

Why does not the latch extend and the motor isn't rotating when resetting my lock?

The deadbolt latch should be retracted (unlocked) through all your installation process.

Please open your door and reset the lock.

When I attempt to lock/unlock my deadbolt, why does the latch go in and out for a few times?

It happens when the latch and strike are misaligned.

Please make sure the bolt hole on the door frame is at least 1" (25mm) deep, so that the bolt can be fully extended.

Please check if the door can be closed properly, the deadbolt should not impact the strike or door frame on the door frame side, it should go directly into the hole properly.

Why does my lock only work properly when the backup key is in? Why am I unable to pull the key out in the unlocked position?

You may need to re-install the whole lock.

Please make sure when you start to install, the lock is in unlocked status;

Please make sure the turn knob is horizontal.

Please do not put the backup key in the lock.

What does 3 short and fast beeps mean while programming?

It alerts you either time-out or wrong entry.

Please be sure to complete each setting step within 5 seconds.

Please change the default master code in the first time programming.

Please be sure the user code is with correct format and with 6 to 9 digits.

What if I forget my Master Codes?

If you forget your Master code, resetting your lock, then the original master code (123456) works, and all previous user codes were erased.



Warranty

PLEASE NOTE

The warranty period of this product is 12 months from the date of purchase.

The specifications of this product are subject to change without notice. Please note.

The production and sale of this product may be discontinued due to the discontinuation of the electronic parts used.

If you suspect a malfunction of this product, please let us know the following information:

- Order number and product model number
- Failure status (please explain in as much detail as possible.)

For any questions or inquiries regarding malfunctions, please contact us.

The manufacturer will not be held liable for incidental or consequential losses or damages to any act of God.

Customer Support

Need support for setting up your lock? You can:



ELAMOR

Or contact our customer center

Customer Support:

✉ elamor2@afterservice.vip

<https://www.youtube.com/channel/UCYbOQV5c-4xjRvdwm-14aAw>

<https://elamor2.afterservice.vip>

Manufacturer: QingDao Zealing Network Co., Ltd.

Address: No. 8, Tongshun Road, High-Tech Zone,
Qingdao, CHINA 266112