



Designers' Choice

QUICK-FIT TERMINALS

.250 "STURDI-MOUNT" PC QUICK-FIT HEADERS

- Ideal for rugged multi-insertion applications
- Pre-assembled header reduces PC assembly costs
- Increases PC board retention strength
- Keeps terminals perpendicular
- Maintains position for wave soldering

AVAILABLE WITH TIN PLATED BRASS OR STEEL TABS

SPECIFICATIONS

Material: .032, Brass or Steel, Tin Plate

Insulator: Noryl, UL rated 94V-0

Voltage Rating: 500VAC; Current Rating: 15 Amps

Temperature Rating: -58°F to +292°F (-50°C to +145°C)



.250 HORIZONTAL

BRASS TABS CAT. NO.	STEEL TABS CAT. NO.	NO. TABS	A DIM.
7802	7822	2	.362
7803	7823	3	.562
7804	7824	4	.762
7805	7825	5	.962
7806	7826	6	1.162

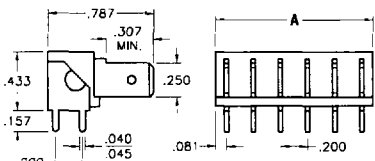

.250 VERTICAL

BRASS TABS CAT. NO.	STEEL TABS CAT. NO.	NO. TABS	A DIM.
7812	7832	2	.362
7813	7833	3	.562
7814	7834	4	.762
7815	7835	5	.962
7816	7836	6	1.162

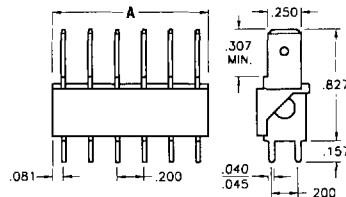

Mtg. Holes: .052 Dia. x .200 Centers

- Stabilized mounting
- Protects PCB Joints

.187 / .250 "STURDI-MOUNT" PC QUICK-FIT TERMINALS

.187 TAB

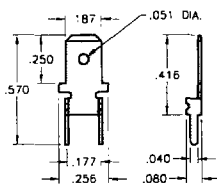

CAT. NO.	MATERIAL	MTG. HOLES
4900	.020 Brass, Tin Plate	.043 Dia.

.250 TAB

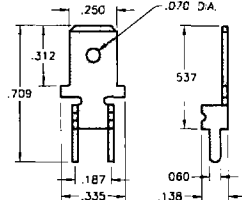

CAT. NO.	MATERIAL	MTG. HOLES
4901	.032 Brass, Tin Plate	.067 Dia.

.250 TAB

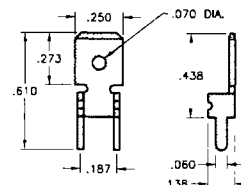

CAT. NO.	MATERIAL	MTG. HOLES
4902	.032 Brass, Tin Plate	.067 Dia.

45° & 90° QUICK-FIT RIVET TYPES

.110 / .187 / .250 TABS

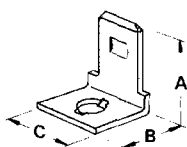

90 Degree MATERIAL: Bright Brass

CAT. NO.	TAB SIZE	MAT THICK	A	B	C	HOLE DIA
2002	.110	.020	.350	.383	.180	.096
1261	.187	.020	.312	.250	.250	.099
1256	.250	.032	.405	.312	.312	.130

.110 / .187 / .250 TABS

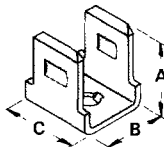

90 Degree MATERIAL: Bright Brass

CAT. NO.	TAB SIZE	MAT THICK	A	B	C	HOLE DIA
2003	.110	.020	.350	.383	.180	.096
1262	.187	.020	.312	.250	.250	.099
1257	.250	.032	.405	.343	.312	.130

.250 TAB

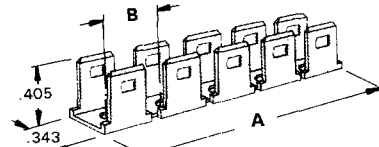

MULTIPLE 90° MATERIAL: Bright Brass

CAT. NO.	TAB SIZE	MAT THICK	A	B	HOLE DIA	PAIRS
1005	.250	.032	.703	.375	.130	2
1006	.250	.032	1.075	.375	.130	3
1007	.250	.032	1.422	.375	.130	4
1008	.250	.032	1.837	.375	.130	5

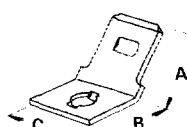

45 Degree MATERIAL: Bright Brass

CAT. NO.	TAB SIZE	MAT THICK	A	B	C	HOLE DIA
2004	.110	.020	.350	.383	.180	.096
1271	.187	.020	.312	.250	.250	.099
1280	.250	.032	.405	.312	.312	.130



45 Degree MATERIAL: Bright Brass

CAT. NO.	TAB SIZE	MAT THICK	A	B	C	HOLE DIA
2005	.110	.020	.350	.383	.180	.096
1263	.187	.020	.343	.375	.265	.099
1258	.250	.032	.405	.343	.312	.130

CUSTOM QUICK-FIT TERMINALS and CUSTOM STAMPINGS

Custom quick-fit terminals can be manufactured to your specifications.

Complete facilities available to meet your production requirements.

Quotations on special stampings furnished promptly upon receipt of sample, sketch or print.

PC QUICK-FIT TERMINALS

Designers' Choice



.110 / .187 / .205 PC QUICK-FIT MALE TYPES

.110 TAB

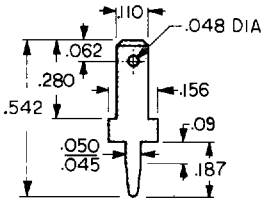

.187 TAB

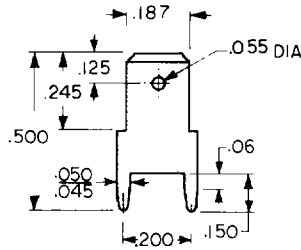

.205 TAB

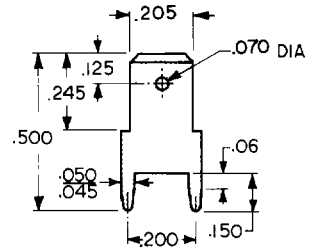

CAT. NO.	MATERIAL	MTG. HOLE
1267	.020 Brass, Tin Plate	.046 Dia.
1211	.032 Brass, Tin Plate	.052 Dia.

Hand Insertion Tool: Cat. No. 1288

CAT. NO.	MATERIAL	MTG. HOLES
1285	.020 Brass, Tin Plate	.046 Dia.
1212	.032 Brass, Tin Plate	.052 Dia.

Hand Insertion Tool: Cat. No. 1288

CAT. NO.	MATERIAL	MTG. HOLES
1286	.020 Brass, Tin Plate	.046 Dia.
1213	.032 Brass, Tin Plate	.052 Dia.

Hand Insertion Tool: Cat. No. 1288

DUAL .110/.250 TAB

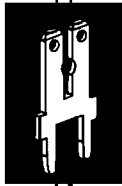
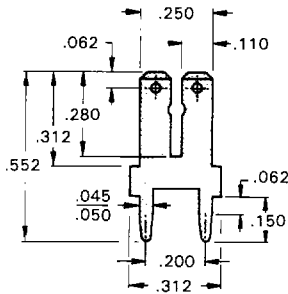

.250 TAB

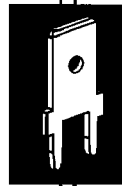
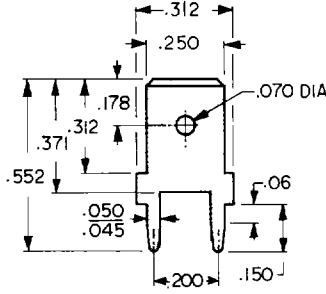

.250 TAB

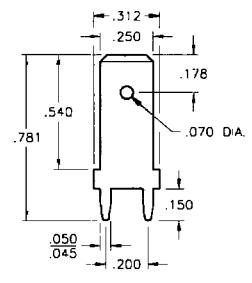

CAT. NO.	MATERIAL	MTG. HOLES
1282	.032 Brass, Tin Plate	.052 Dia.

Hand Insertion Tool: Cat. No. 1288

CAT. NO.	MATERIAL	MTG. HOLES
1287	.032 Brass, Tin Plate	.052 Dia.

Hand Insertion Tool: Cat. No. 1288

CAT. NO.	MATERIAL	MTG. HOLES
1289	.032 Brass, Tin Plate	.052 Dia.

Hand Insertion Tool: Cat. No. 1288

.110 TAB

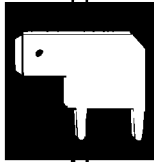
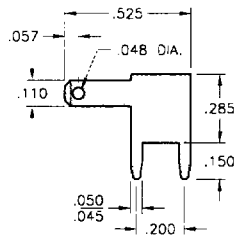

.187 TAB

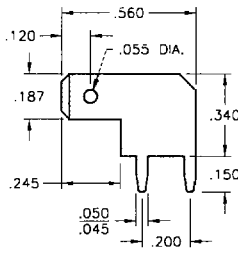

.250 TAB

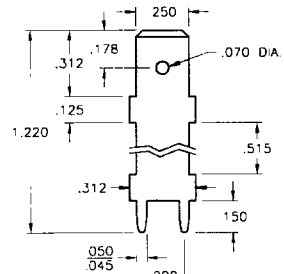

CAT. NO.	MATERIAL	MTG. HOLES
4903	.020 Brass, Tin Plate	.046 Dia.
4906	.032 Brass, Tin Plate	.052 Dia.

CAT. NO.	MATERIAL	MTG. HOLES
4904	.020 Brass, Tin Plate	.046 Dia.
4907	.032 Brass, Tin Plate	.052 Dia.

CAT. NO.	MATERIAL	MTG. HOLES
1281	.032 Brass, Tin Plate	.052 Dia.

Hand Insertion Tool: Cat. No. 1288

.250 TAB

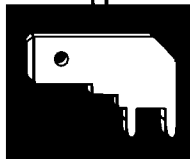
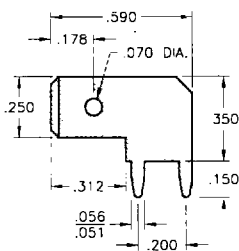

.250 TAB

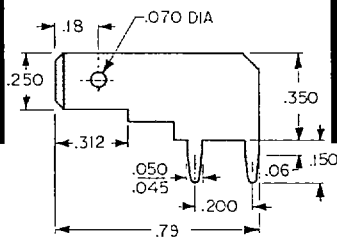

.250 TAB

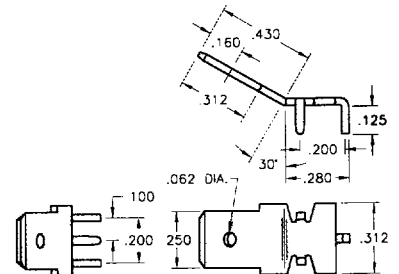

CAT. NO.	MATERIAL	MTG. HOLES
4966	.032 Brass, Tin Plate	.056 Dia.

CAT. NO.	MATERIAL	MTG. HOLES
1266	.032 Brass, Tin Plate	.052 Dia.

CAT. NO.	MATERIAL	MTG. HOLES
4908	.032 Brass, Tin Plate	.052 Dia.



Designers' Choice

QUICK-FIT TERMINALS

.110 / .187 / .205 / .250 PC QUICK-FIT FEMALE TYPES

.110 HORIZONTAL

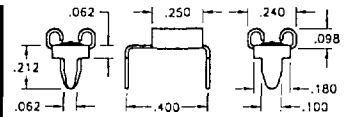
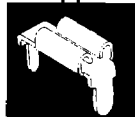
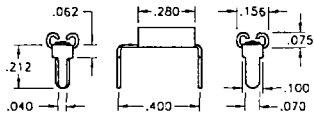

.250 HORIZONTAL

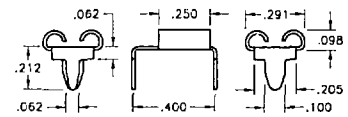

MATERIAL:
.012 Brass, Nickel Plate

CAT. NO.	ACCEPTS TAB
3545	.110 x .020
3549	.110 x .032

Mounting Detail

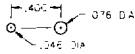

MATERIAL:
.012 Brass, Nickel Plate

CAT. NO.	ACCEPTS TAB
3546	.205 x .020
3550	.205 x .025
	.205 x .032

Mounting Detail

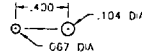

MATERIAL:
.016 Brass, Nickel Plate

CAT. NO.	ACCEPTS TAB
3547	.250 x .032

Mounting Detail

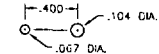

.110 VERTICAL

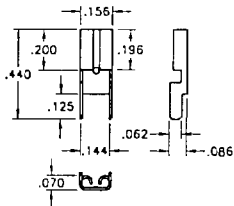

.205 VERTICAL

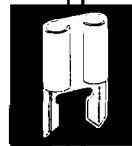
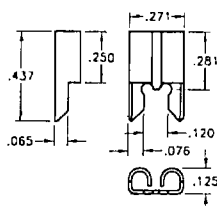

.250 VERTICAL

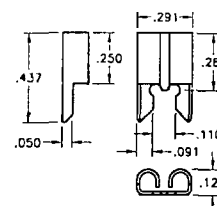

MATERIAL:
.012 Brass, Nickel Plate

CAT. NO.	ACCEPTS TAB
3534	.110 x .020
3544	.110 x .032

Mounting Detail

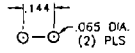

MATERIAL: Brass, Nickel Plate

CAT. NO.	ACCEPTS TAB	MAT. THICK
3525	.205 x .020	.012
3522	.205 x .025	.016
	.205 x .032	.016

Mounting Detail

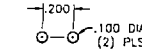

MATERIAL:
.016 Brass, Nickel Plate

CAT. NO.	ACCEPTS TAB
3528	.250 x .032

Mounting Detail

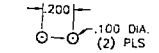

.187 VERTICAL

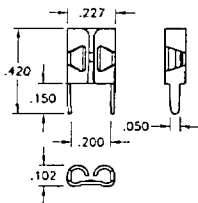

MATERIAL:
.016 Brass, Tin Plate

CAT. NO.	ACCEPTS TAB
3548	.187 x .020
3551	.187 x .032

Mounting Detail

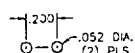

QUICK-FIT FEMALES

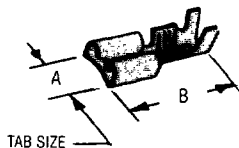

MATERIAL: Tinned Brass

CAT. NO.	A DIM TAB SIZE	B DIM LENGTH	AWG SIZE	MAT. THICK
1252	.110 x .020	.640	18-22	.010
1264	.187 x .020	.576	16-22	.013
4469	.205 x .020	.640	16-20	.013
4470	.250 x .032	.750	16-20	.016

.250 QUICK-FIT VINYL BOOT



- Easily slips over terminal.
- Insulated and protects.

CAT. NO.	BOOT COLOR
4471	CLEAR
4472	RED
4473	BLUE
4474	YELLOW

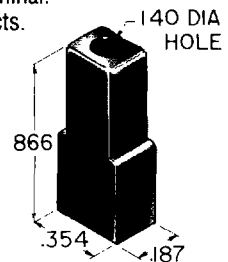

.110 / .187 / .205 QUICK-FIT RIVET TYPES

.110 TABS

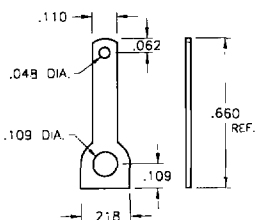

.110 TABS

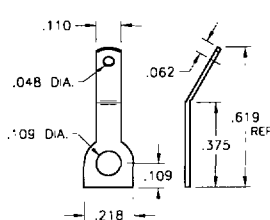

.187 / .205 TABS

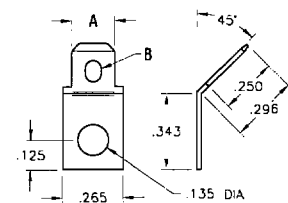

CAT. NO.	MATERIAL
1269	.020 Brass, Tin Plate

CAT. NO.	MATERIAL
1270	.020 Brass, Tin Plate

CAT. NO.	MATERIAL	A	B
4005	.020 Brass, Tin Plate	.205	.132 x .070 Slot
4095	.020 Brass, Tin Plate	.187	.078 Dia. Hole